

the Group Head Cleaner™

BCC201 & BCC202



Breville®

the Group Head Cleaner™

BCC201 = 6 X 5 g
BCC202 = 12 x 5 g

NOTE

The provided recommendations for standard cleaning products are based on general usage. Individual results may vary depending on specific conditions and personal preferences.

For optimal performance, Breville recommends using its own certified cleaning products.

Backflushing cleans the group head of rancid coffee oils. This cleaning process may vary depending on machine usage. For a machine used daily at home, it is recommended to backflush every 2-4 weeks.

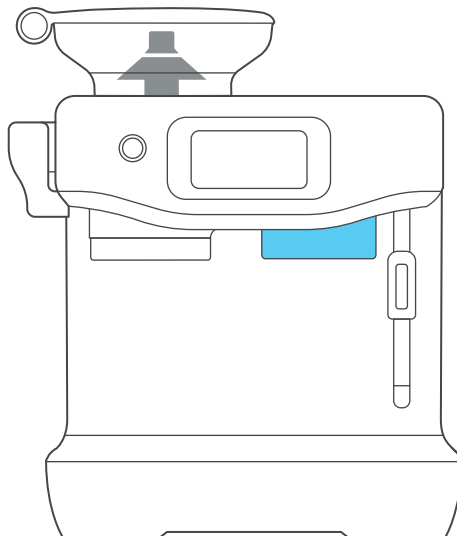

1

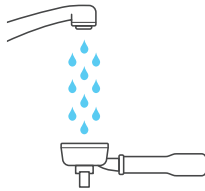

2

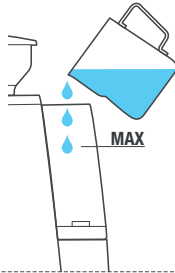

3

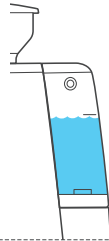

4

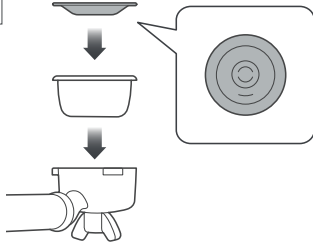

5



6

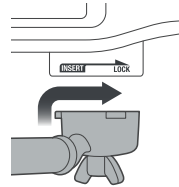

7

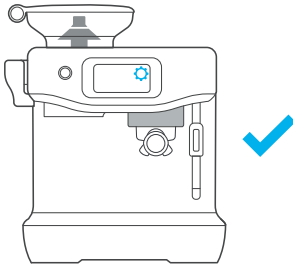

Breville Service Centre

Australian Customers

Phone: 1300 139 798

Web: www.breville.com

New Zealand Customers

Phone: 0800 273 845

Web: www.breville.com

Breville®

Master Every Moment™

Breville, the Breville Logo, is trademark of Breville Pty Ltd ("Breville") and Breville's products are distributed in Australia and New Zealand under license.

Copyright Breville Pty. Ltd. 2026.

Due to continued product improvement, the products illustrated/photographed in this brochure may vary slightly from the actual product.